

INFLUENZA A+B

RAPID TEST



SIMPLE, RAPID AND ACCURATE



NASOPHARYNGEAL
SWAB



OROPHARYNGEAL
SWAB



The Influenza A+B Rapid Test Cassette is a rapid chromatographic immunoassay for the qualitative detection of influenza type A and B nucleoprotein antigens in nasopharyngeal swab and oropharyngeal swab.

This kit is intended to be used as an aid in the diagnosis of influenza A and influenza B virus in nasopharyngeal swab and oropharyngeal swab.

SPECIMEN COLLECTION

Specimens obtained early during symptom onset will contain the highest viral titers; specimens obtained after five days of symptoms are more likely to produce negative results. Inadequate specimen collection, improper specimen handling and/or transport may yield a falsely negative result; therefore, training in specimen collection is highly recommended due to the importance of specimen quality for generating accurate test results.



Nasopharyngeal Swab Sample

Insert minitip swab with a flexible shaft (wire or plastic) through the nostril parallel to the palate (not upwards) until resistance is encountered or the distance is equivalent to that from the ear to the nostril of the patient, indicating contact with the nasopharynx. Swab should reach depth equal to distance from nostrils to outer opening of the ear. Gently rub and roll the swab. Leave swab in place for several seconds to absorb secretions. Slowly remove swab while rotating it. Specimens can be collected from both sides using the same swab, but it is not necessary to collect specimens from both sides if the minitip is saturated with fluid from the first collection. If a deviated septum or blockage creates difficulty in obtaining the specimen from one nostril, use the same swab to obtain the specimen from the other nostril.



Oropharyngeal Swab Sample

Insert swab into the posterior pharynx and tonsillar areas. Rub swab over both tonsillar pillars and posterior oropharynx and avoid touching the tongue, teeth, and gums.

SPECIMEN PREPARATION

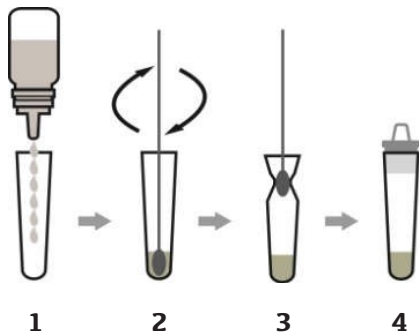

1. Add 0.5 mL (16 drops) of the specimen extraction reagent into the extraction tube, and put it on the work station.

2. Insert the swab into the extraction tube which contains 0.5 mL (16 drops) of the extraction buffer. Rotate the swab inside the tube using a circular motion to roll the side of the extraction tube so that the solution is expressed and reabsorbed from the swab.

Leave the swab in the Reagent Tube for one minute.

3. Pinch the extraction tube with fingers and remove the solution from the swab as far as possible. The extracted solution will be used as test specimen.

4. Insert a nozzle with filter into the specimen extraction tube tightly.

INTERPRETATION OF RESULTS

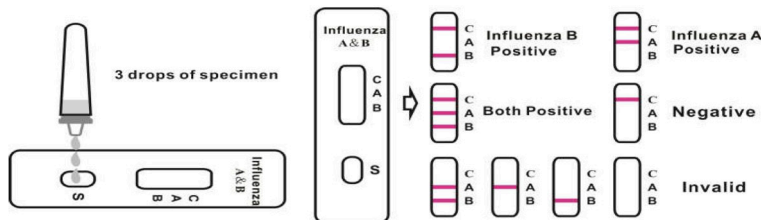

(THE PICTURE IS FOR REFERENCE ONLY, PLEASE REFER TO THE MATERIAL OBJECT)

Positive: Control line and at least one test line appear on the membrane. The appearance of A test line indicates the influenza type A positive. The appearance of B test line indicates the influenza type B positive. And if both A and B line appear, it indicates that the presence of both influenza type A and B positive.

Negative: One colored line appears in the control region(C). No apparent colored line appears in the test line region.

Invalid: LControl line fails to appear. Insufficient specimen volume or incorrect procedural techniques are the most likely reasons for control line failure. Review the procedure and repeat the test using a new test cassette. If the problem persists, discontinue using the lot immediately and contact local distributor.

Wait for colored lines to appear. Interpret the test results at 15 minutes.
Do not read results after 20 minutes.

PRODUCT CODE	DESCRIPTION	CODE
INF-AB	Influenza A+B Rapid Test	BOX of 20 / 25

More than surgery

ITALIA

Stabilimento di Produzione

Zona Industriale
67062 Magliano dei Marsi (AQ), Italy
Tel. +39 0863 517956/515000
Fax +39 0863 570084/515209

Ufficio Legale

Via G. Gregoraci, n.12
00173 Roma
Tel. +39 06 72677348
Fax +39 06 72675380

FRANCE

86-114 Avenue Louis Roche
Batiment D Hall-3 92230
Gennevilliers
Tel. +33 147985294
Fax +33 147985892

ESPAÑA

Poligono Landaben
Calle C, nave 1y2 - 31012
Pamplona (Navarra)
Tel. +34 948122274
Fax. +34 948120842

GERMANY

Prager Strasse 34
04317 Leipzig

UK

Unit 12a Barncliffe Mills
Shelley HD8 8LU Huddersfield
Tel. +44 1484602222



USA

55 NE 5th Avenue, Suite 501
33432 - 4093 Boca Raton FL
United States

RUSSIAN FEDERATION

c/o Studio Marzona
Rozhdestvenskiy B-r 10 Bld. 7
107031 Moscow
Tel/Fax +7 962 9862804

BRASIL

Rua Professor Alfredo Gomes, 14
CEP 22551-080
Botafogo Rio De Janeiro (RJ)
Tel.: 0055 21 22661943
Fax: 0055 21 22663539

ALGERIE

Zone D'Activité Dar El Beida
Lot n° 66, Bt 12
Alger

TUNISIE

Rue 7316 Villa n°5 - El Menzah 9B
1013 Tunis, Tunisie
Tel.: 00216 71875740
Fax: 00216 71880541

www.assuteurope.com

info@assuteurope.com

